

## TU - L5

LUBRICATOR  
LUBRIFICATORE

## FLOW / PORTATA

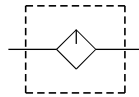
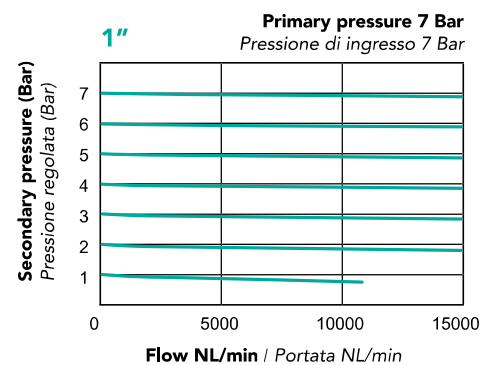
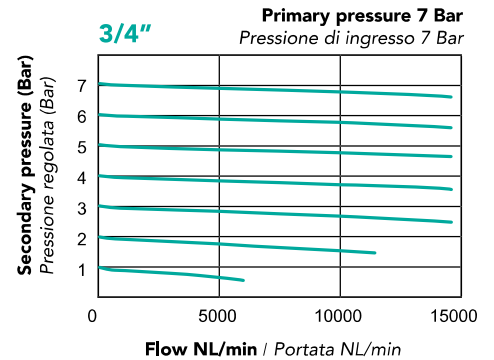

## Attachment / Accessori

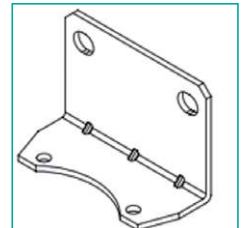
L-type bracket (TU-BC5)  
Staffa a L (TU-BC5)

## TECHNICAL FEATURES / CARATTERISTICHE TECNICHE

<b>Port size / Taglia</b>	G 3/4" G 1"
<b>Fluid / Fluido</b>	Air / Aria
<b>Operating pressure range</b> Range di pressione operativa	0,5 ~ 10 Bar
<b>Proof pressure</b> Pressione di scoppio	PC bowl / Tazza protetta: 15 Bar Metal bowl / Tazza in metallo: 20 Bar
<b>Ambient temperature</b> Temperatura ambiente	- 5 ~ +60°C (no freezing - no congelamento)
<b>Lubricating oil capacity</b> Capacità tazza olio	200 cc
<b>Min. flow for oil drip</b> Flusso minimo gocciolamento olio	25 L/min
<b>Recommended lubricating oil</b> Olio di lubrificazione consigliato	ISO-VG32
<b>Weight / Peso</b>	PC bowl / Tazza protetta: 1260 g Metal bowl / Tazza in metallo: 1380 g
<b>Attachment / Accessori</b>	C-type bracket (TU-BC5) Staffa a C (TU-BC5)

ENCODING / CODIFICA

TU - L5 - □ - □

<p><b>Model</b> Modello</p>	<p><b>Port size:</b> Connessione: 34 3/4" 10 1"</p>	<p><b>Bowl /Tazza:</b> P Protection case Tazza protetta M Metal bowl Tazza di metallo</p>
---------------------------------	-----------------------------------------------------------------	-----------------------------------------------------------------------------------------------------------

DIMENSIONS / DIMENSIONI

