

TU - BL2**L Bracket**
Staffa a L**TU - BT2****T Bracket**
Staffa a T**TU - BC2F****Bracket for F unit**
Staffa per unità F**TU - BC2L****Bracket for L unit**
Staffa per unità L

TU - BVS2

Bracket for TU-VS2
Staffa per TU-VS2

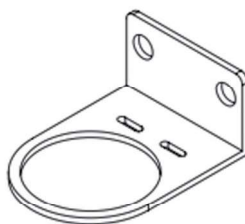
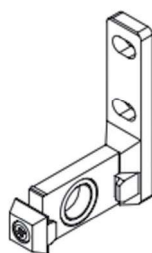
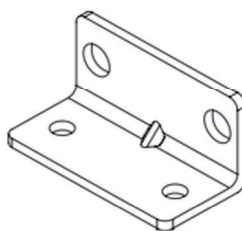
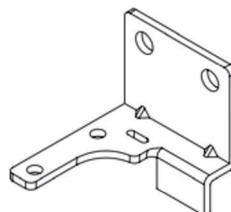
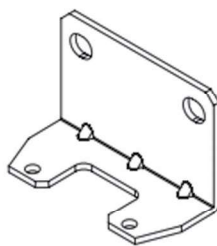

TU - FE2

40 micron filter
Filtro 40 micron



TU - FX2

5 micron filter
Filtro 5 micron

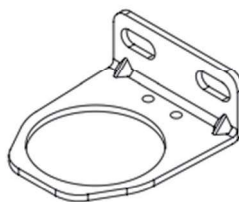

TU - BL3

L Bracket
Staffa a L

TU - BT3

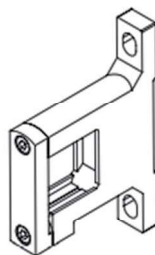
T Bracket and joiner
Staffa a T a giunzione

TU - BC3

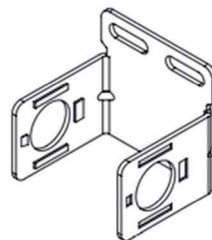
C Bracket for F, MMF
Staffa a C per unità F, MMF e L

TU - BS3

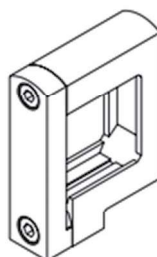
Joiner unit
Giunzione

TU - BVM

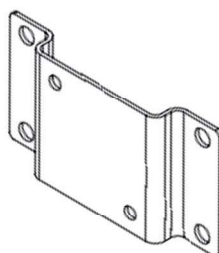
Bracket for TU - VM3
Staffa per TU - VM3

TU - BVS3

Bracket for TU - VS3
Staffa per TU - VS3

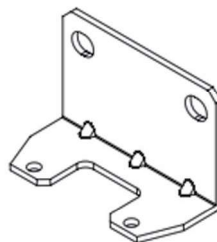

TU - T3 - 14, 38, 12

Module mounting bracket
Blocchetto di derivazione

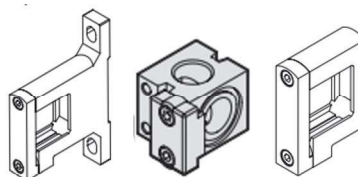

TU - K3 - 14, 38

Module bracket with check valve
*Blocchetto di derivazione
con valvola di non ritorno*

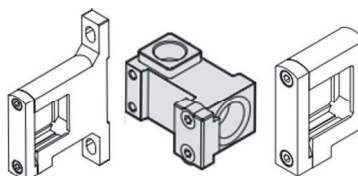

TU - FE3

40 micron filter
Filtro 40 micron



TU - FX3

5 micron filter
Filtro 5 micron



ACCESSORIES FOR TU - 4 AND TU -4H

ACCESSORI PER TU - 4 E TU - 4H

TU - BL4

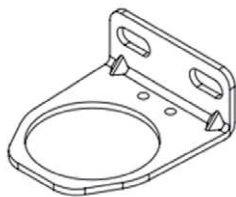

L Bracket for TU - R4 and TU - R4H
Staffa a L per TU - R4 and TU - R4H

TU - BFR4

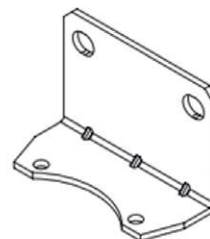

Bracket for TU - FR4 and TU - FR4H
Staffa per TU - FR4 and TU - FR4H

TU - BT4

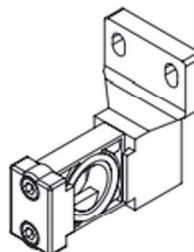

T Bracket and joiner
Staffa a T a giunzione

TU - BC4

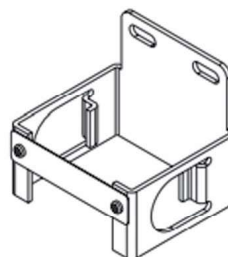

C Bracket for F, MMF and L units
Staffa a C per unità F, MMF e L

TU - BS4

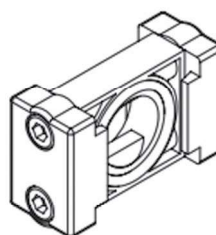

Joiner unit
Giunzione

TU - BVM

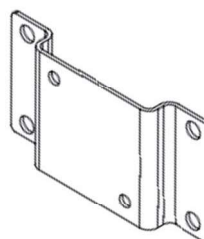

Bracket for TU VM 4
Staffa per TU VM 4

TU - BVS4

Bracket for TU VS 4
Staffa per TU VS 4

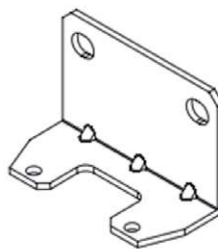

TU - T4 - 12

Module mounting bracket
Blocchetto di derivazione

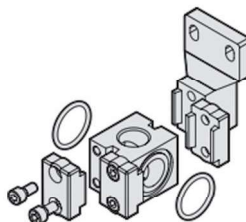

TU - K4 - 38

Module bracket with check valve
*Blocchetto di derivazione
con valvola di non ritorno*

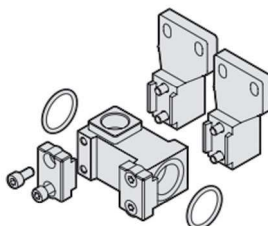

TU - FE4

40 micron filter
Filtro 40 micron



TU - FX4

5 micron filter
Filtro 5 micron

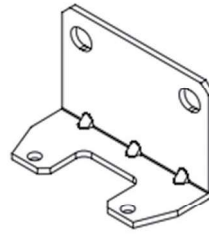
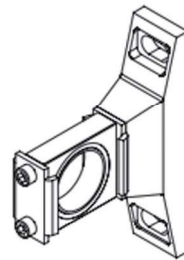
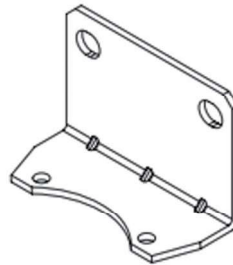
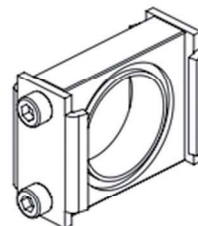

TU - BL5**L Bracket**
Staffa a L**TU - BT5****T Bracket and joiner**
Staffa a T e giunzione**TU - BC5****Bracket for F and L units**
Staffa per unità F e L**TU - BS5****Joiner unit**
Giunzione

TU - T5 - 12

Module mounting bracket
Blocchetto di derivazione

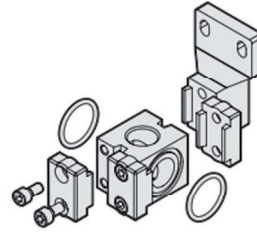

TU - J5

Panel mounting nut
Dado per montaggio a pannello



TU - AS

**1/8" gauge adapter set for TU-3, TU-4,
TU-5 R and FR units**

Adattatore per manometro 1/8" per le
unità R e FR TU-3, TU-4, TU-5.

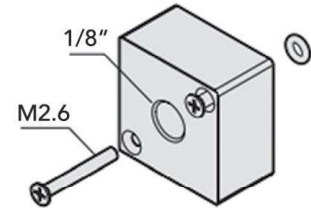

GAUGE / MANOMETRO G1/8

Code / Codice	Connections / Conessioni	Series / Serie
K MM40 06 Ø40 0÷6 Bar	G 1/8"	TU-2, TU-3, TU-4, TU-4H, TU-5
K MM40 12 Ø40 0÷12 Bar	G 1/8"	TU-2, TU-3, TU-4, TU-4H, TU-5
K MM50 06 Ø50 0÷6 Bar	G 1/8"	TU-2, TU-3, TU-4, TU-4H, TU-5
K MM50 12 Ø50 0÷12 Bar	G 1/8"	TU-2, TU-3, TU-4, TU-4H, TU-5
K MM63 12 Ø63 0÷12 Bar	G 1/4"	TU-6, TU-7



PLUG / GRANO

Code / Codice	Connections / Conessioni	Series / Serie
K GC18	G 1/8"	TU-2, TU-3, TU-4, TU-4H, TU-5
K GC14	G 1/4"	TU-6, TU-7

